

# WET CLUTCH-BRAKE SERIES 5.W

## FRENO-EMBRAGUES OLEONEUMÁTICO SERIE 5W

This series of clutch-brake is the version of the pneumatic actuated and hydraulically cooled multiplate clutch-brake.

It combines the engagement of the pneumatic clutch-brake, with the cooling capacity of the hydraulic clutch-brakes. As a result, we obtain a clutch-brake with the possibility of a high frequency of engagements.

The disc can be cooled by oil bath, (no external cooling) or by forced cooling (pumped oil circuit) depending on the required dissipation energy of the application.

Éste es el freno-embrague multidisco actuado neumáticamente y refrigerado por aceite.

Esta serie de freno-embrague combina el accionamiento del embrague neumático con la capacidad de refrigeración de los embragues hidráulicos. Como resultado tenemos un frenoembrague con la posibilidad de obtener una alta frecuencia de maniobras.

La refrigeración se produce dependiendo de la energía de disipación requerida por la aplicación, esta refrigeración puede ser forzada por medio de un circuito exterior, para lo cual el freno-embrague está preparado.

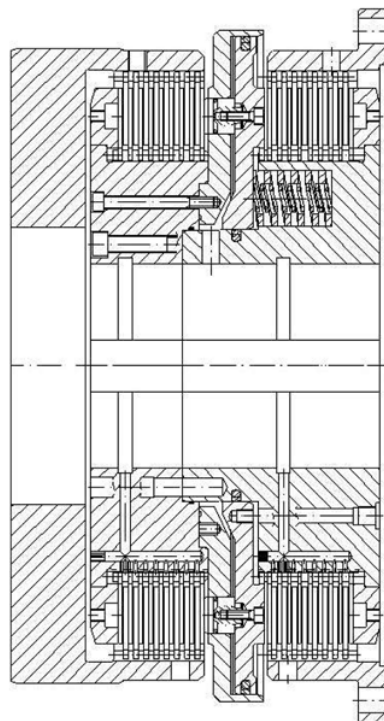

## Series 5.W1

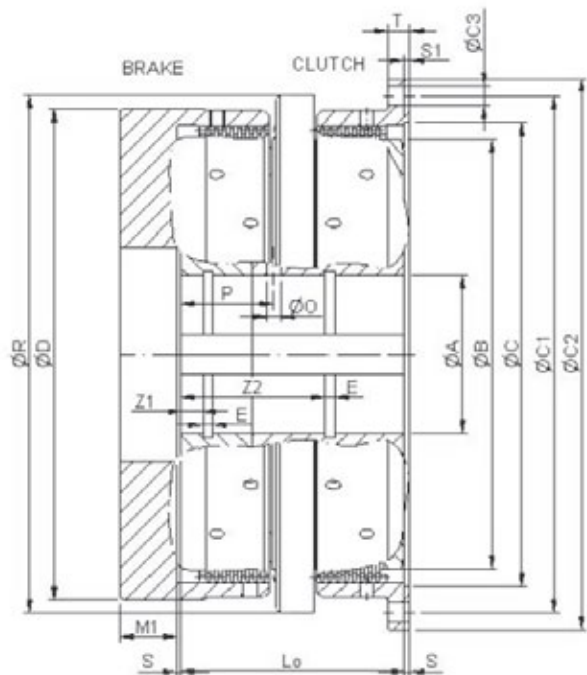

## Series 5.W5

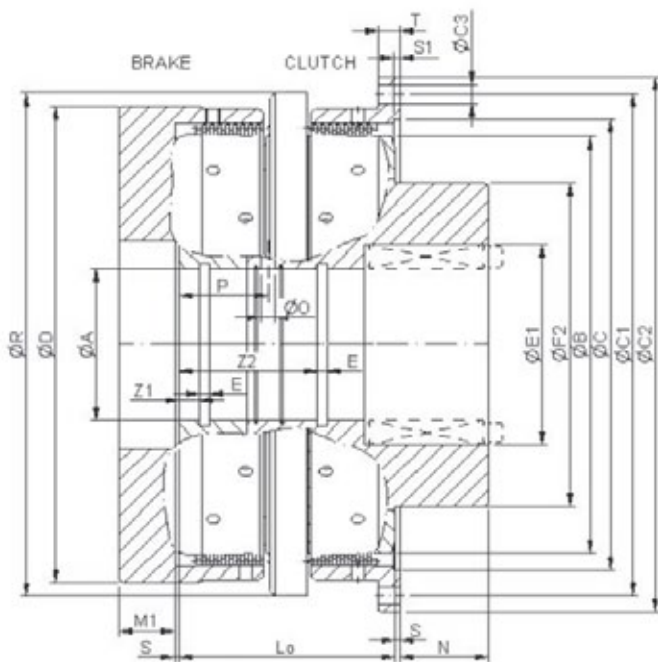

# PNEUMATIC CLUTCH-BRAKES / FRENO-EMBRAGUES NEUMÁTICOS

SERIES			5.W1	5.W5	5.W1	5.W5	5.W1	5.W5	5.W1	5.W5	5.W1	5.W5
SIZE			75	77	78	78	81	81	82	82		
DYNAMIC BRAKE TORQUE	Brake side discs= 5	Nm	1460	2700	5400		10800		20600			
	Brake side discs= 6		1760	3300	6500		13000		24700			
	Brake side discs= 7		2050	3800	7600		15200		28800			
	Brake side discs= 8		2350	4400	8700		17300		32900			
	Brake side discs= 9		2640	4900	9800		19500		37000			
	Brake side discs= 10		2930	5500	10900		21700		41200			
STATIC CLUTCH TORQUE	Clutch side discs= 5	Nm	3270	6300	10000		21300		45900			
	Clutch side discs= 6		3910	7600	12000		25500		54700			
	Clutch side discs= 7		4540	8800	13900		29600		63400			
	Clutch side discs= 8		5150	10000	15800		33600		72000			
	Clutch side discs= 9		5770	11300	17600		37700		80600			
	Clutch side discs= 10		6370	12500	19500		41600		89200			
Max speed		min <sup>-1</sup>	1300	1000	850		700		500			
Pressure		bar	5,5									
Weight ( 8+8 discs )		Kg	91	101	174	202	284	319	530	613	1076	1181
J. int.	Total discs= 10	Kg m <sup>2</sup>	0,44	0,51	1,13	1,41	2,92	3,48	8,54	10,38	31,31	36,27
	Total discs= 20		0,57	0,64	1,47	1,75	3,75	4,31	10,87	12,71	40,38	45,33
Weight ( 8+8 discs )		dm <sup>3</sup>	0,25	0,47	0,77		1,38		2,77			
Ø A		min. max.	70	80	105		120		160			
			95	115	150		180		250			
Ø B			260	320	390		490		630			
Ø C ( H7 )			277	350	415		530		670			
Ø C <sub>1</sub>			310	400	470		590		750			
Ø C <sub>2</sub> ( g7 )			330	425	500		630		800			
Ø C <sub>3</sub>	12 x 30°		11	13,5	17,5		22		26			
Ø D			296	380	440		560		710			
E			8	12	12		12		15			
E <sub>1</sub> max.			135	155	200		235		305			
F <sub>2</sub>			200	250	300		380		475			
L <sub>0</sub>	Total discs= 10		131	136	176		204		270			
	Total discs= 12		143	149	192		222		294			
	Total discs= 14		155	162	208		240		318			
	Total discs= 16		167	175	224		258		342			
	Total discs= 18		179	188	240		276		366			
	Total discs= 20		191	201	256		294		390			
M <sub>1</sub>			40	50	60		65		75			
N			70	108	116		132		174			
Ø O	2 x 180°		8	10	13		16		20			
P	Brake side discs= 5		46	48,5	64		78		106			
	Brake side discs= 6		52	55	72		87		118			
	Brake side discs= 7		58	61,5	80		96		130			
	Brake side discs= 8		64	68	88		105		142			
	Brake side discs= 9		70	74,5	96		114		154			
	Brake side discs= 10		76	81	104		123		166			
R			311	388	468		592		755			
S			5	5	5		5		5			
S <sub>1</sub>			6	6	6		6		6			
T			12	16	20		25		30			
Z <sub>1</sub>			14	14,5	26,5		24		32			
Z <sub>2</sub>	Brake side discs= 5		91	96,5	129		141		186			
	Brake side discs= 6		97	103	137		150		198			
	Brake side discs= 7		103	109,5	145		159		210			
	Brake side discs= 8		109	116	153		168		222			
	Brake side discs= 9		115	122,5	161		177		234			
	Brake side discs= 10		121	129	169		186		246			

FOR DRAWINGS, SPECIFICATIONS AND QUESTIONS REGARDING A GOIZPER PRODUCT, PLEASE CONTACT US:  
Toll-Free: 1-800-813-0844 | Phone: 1-941-358-9447 | Fax: 1-941-358-9647 | Email: sales@goizperusa.com | www.goizperusa.com



Torque Technologies, the exclusive U.S. stocking agency of GOIZPER Clutches, Brakes and Clutch-Brakes provides expert, computerized application engineering and retrofit services to customers across the USA.

## AIR ROTARY INLET / RACORES GIRATORIOS

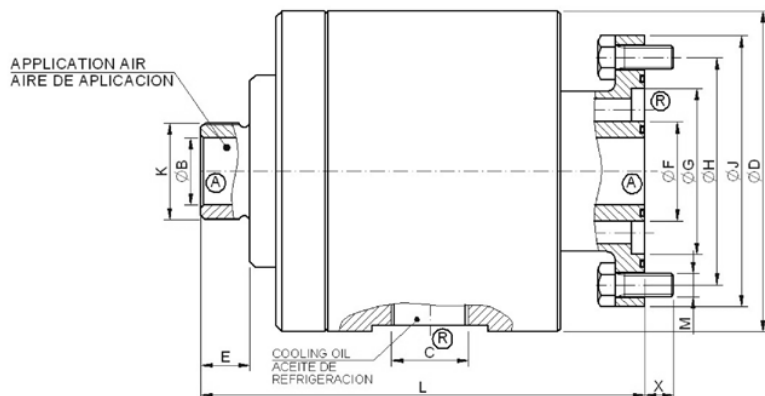

SERIES	7.07.12.908	7.07.03.912	7.07.04.909
Ø B	14	23	32
E	1/2"Gas	3/4"Gas	1"Gas
Ø D	90	110	136
E	15	17	22
Ø F	26	34	43
Ø G	44	57	72
Ø H	64	78	100
Ø J ( g6 )	75	93	118
K	3/4"GAS	1"GAS	1 1/2"GAS
L	140	153	184
M	M6 ( 4x90° )	M8 ( 4x90° )	M10 ( 4x90° )
X	10	10	16
For sizes	75-77	78-81	82

## ASSEMBLY EXAMPLE / EJEMPLO DE MONTAJE

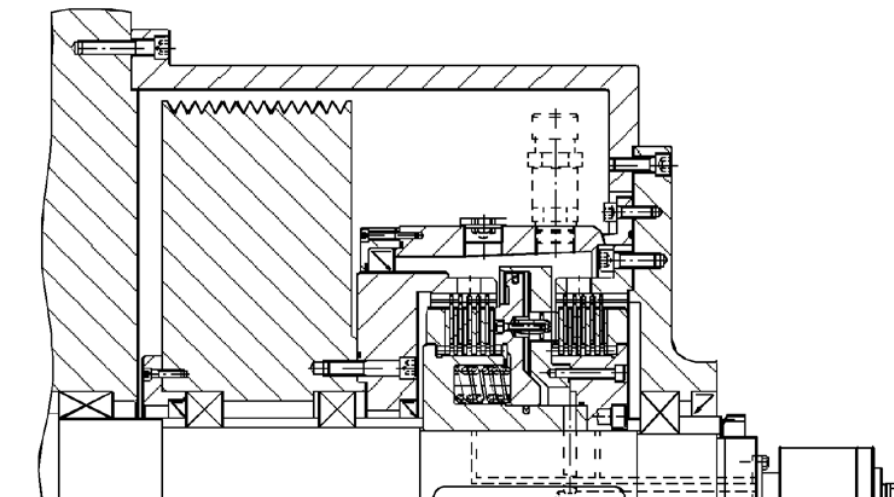

FOR DRAWINGS, SPECIFICATIONS AND QUESTIONS REGARDING A GOIZPER PRODUCT, PLEASE CONTACT US:  
 Toll-Free: 1-800-813-0844 | Phone: 1-941-358-9447 | Fax: 1-941-358-9647 | Email: sales@goizperusa.com | www.goizperusa.com



Torque Technologies, the exclusive U.S. stocking agency of GOIZPER Clutches, Brakes and Clutch-Brakes provides expert, computerized application engineering and retrofit services to customers across the USA.